



Spaces in harmony with you

+918470930121 | [www.abcbuildcon.in](http://www.abcbuildcon.in)



+918470930121 | [www.abcbuildcon.in](http://www.abcbuildcon.in)



Welcome to the High Life

+918470930121 | [www.abcbuildcon.in](http://www.abcbuildcon.in)



## Enter a lifestyle that's truly a class apart

House of Hiranandani brings to you a serene lifestyle that is away from the city's cacophony, yet so close to all the essential amenities.

**Welcome to Hebbal - A life ensconced in luxury, comfort and peace.**

Hebbal is well connected to the Outer Ring Road and is well known for its parks, greenery, boating facilities and bird watching activities. It also hosts several companies and business parks, thus offering easy accessibility to the work place.

Equipped with superlative amenities, Hebbal brings alive an ideal urban experience in harmony with nature that enhances the way you live.

Opening statement

+918470930121 | [www.abcbuildcon.in](http://www.abcbuildcon.in)



+918470930121 | [www.abcbuildcon.in](http://www.abcbuildcon.in)

# Apolo

Stability of position

Strategically located to keep everything  
at your beck-and-call



The prime address of Hebbal keeps you close to the city with the Outer Ring Road and Bellary Road. It boasts of a world-class infrastructure that offers excellent connectivity through well-linked roads. The proposed metro lines will further connect Hebbal to different parts of the city.

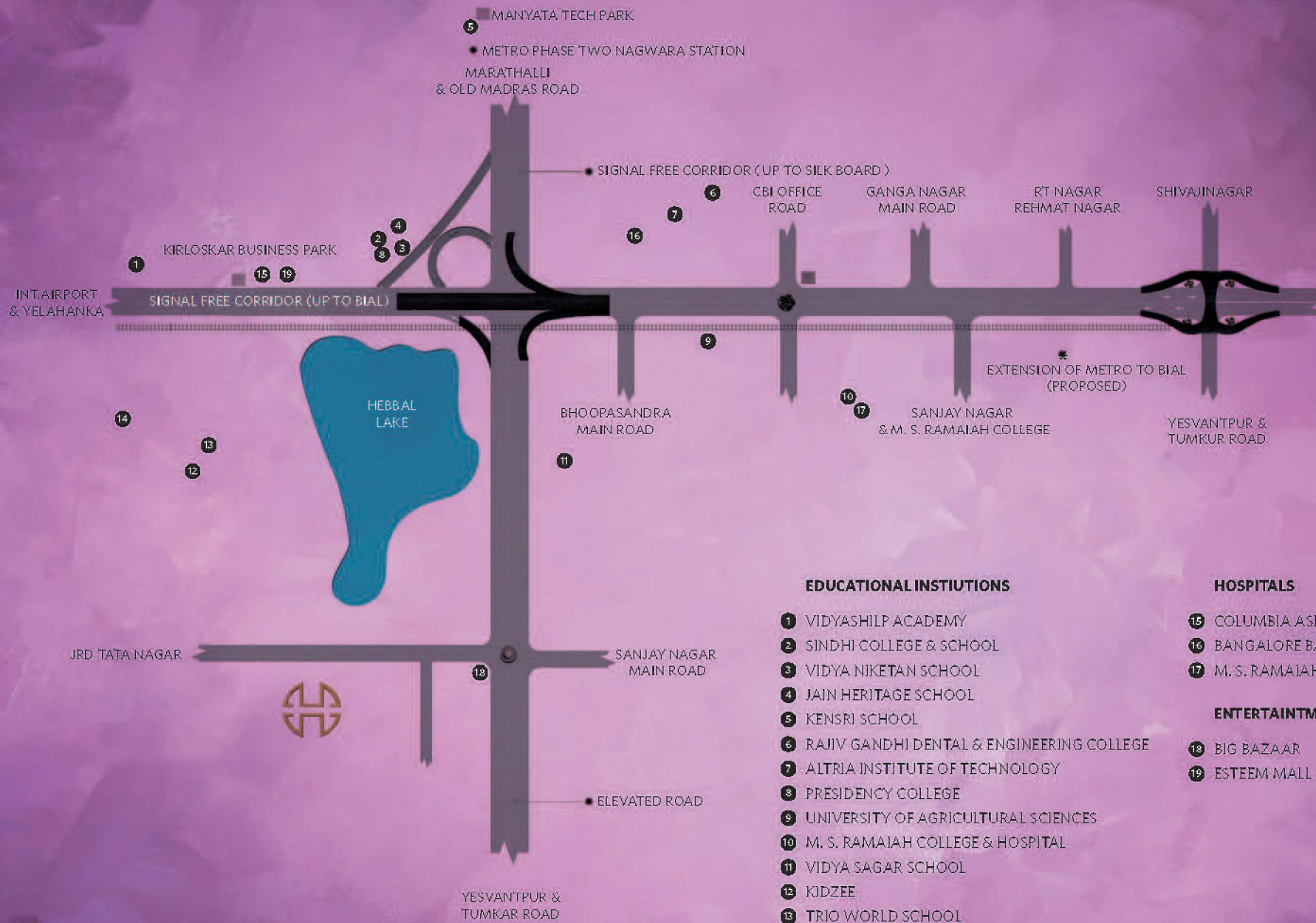

### EDUCATIONAL INSTITUTIONS

- 1 VIDYASHILP ACADEMY
- 2 SINDHI COLLEGE & SCHOOL
- 3 VIDYA NIKETAN SCHOOL
- 4 JAIN HERITAGE SCHOOL
- 5 KENSRI SCHOOL
- 6 RAJIV GANDHI DENTAL & ENGINEERING COLLEGE
- 7 ALTRIA INSTITUTE OF TECHNOLOGY
- 8 PRESIDENCY COLLEGE
- 9 UNIVERSITY OF AGRICULTURAL SCIENCES
- 10 M. S. RAMAIAH COLLEGE & HOSPITAL
- 11 VIDYA SAGAR SCHOOL
- 12 KIDZEE
- 13 TRIO WORLD SCHOOL
- 14 MALLYA ADITI INTERNATIONAL SCHOOL

### HOSPITALS

- 15 COLUMBIA ASIA HOSPITAL
- 16 BANGALORE BAPTIST HOSPITAL
- 17 M. S. RAMAIAH HOSPITAL

### ENTERTAINMENT

- 18 BIG BAZAAR
- 19 ESTEEM MALL

 HOH HEBBAL

\* PROPOSED AS PER GOVERNMENT ANNOUNCEMENT

## Amenities that pamper you

Hebbal's unrivaled amenities assure you of a lifestyle that is simply, a class apart.

It is bestowed with a well-equipped club house, where you can choose to beat the stress in the swimming pool, squash court or badminton court.



Elaborate style

# Bravura

+918470930121 | [www.abcbuildcon.in](http://www.abcbuildcon.in)



Badminton Court

Card Room

Swimming Pool

Landscaping

Water Bodies

**Additional Facilities:**

Fibre to the Home Technology - FTTH

Grand Entrance Lobby

Ample Open Spaces

Neo Classical Architecture

High Speed Lifts

Car Parking Space for Multiple Cars

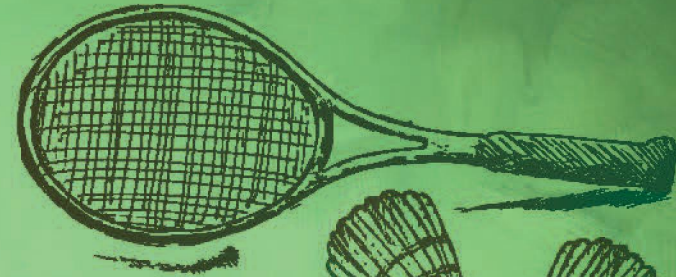

Badminton Court

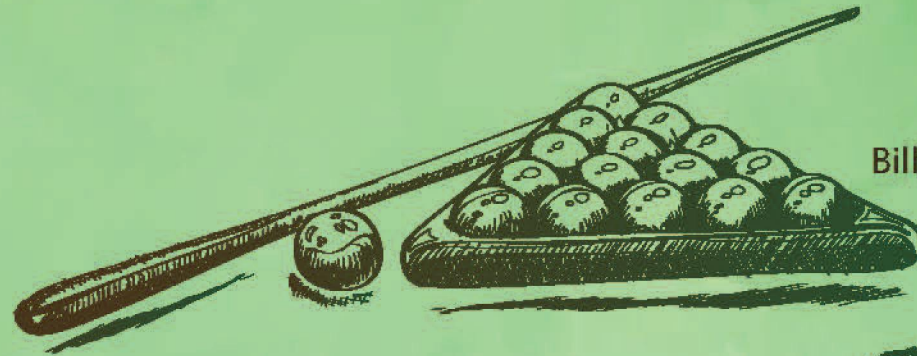

Billiards & Snooker / Pool

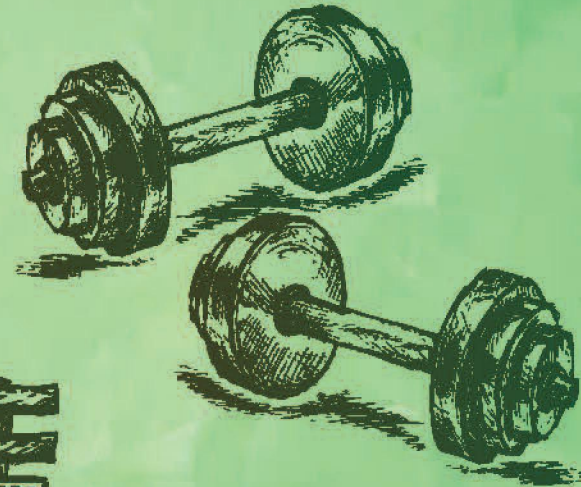

Gym with Aerobics Hall



Resplendent Parks

# PIROUETTE

Spin



Methodical plans for a luxurious life

+918470930121 | [www.abcbuildcon.in](http://www.abcbuildcon.in)

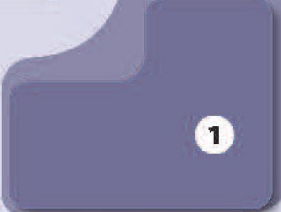
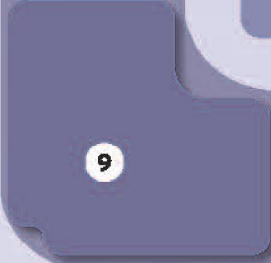
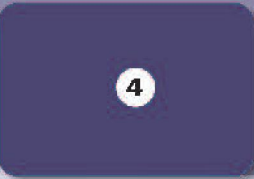
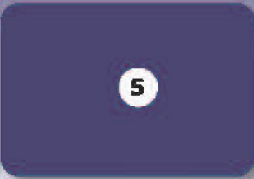
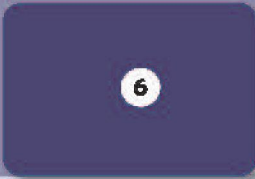

- |                       |                       |
|-----------------------|-----------------------|
| 1 GLEN GATE WING A    | 7 GLEN RIDGE A        |
| 2 GLEN GATE WING B    | 8 GLEN RIDGE B        |
| 3 GLEN GATE WING C    | 9 GLEN RIDGE C        |
| 4 GLEN CLASSIC WING A | 10 FUTURE DEVELOPMENT |
| 5 GLEN CLASSIC WING B | 11 CLUB HOUSE         |
| 6 GLEN CLASSIC WING C |                       |



The plans are subject to approval, change and modification. Location of Future Blocks are only indicative in nature.

# GLEN GATE



- 1 - ENTRANCE FOYER
- 2 - LIVING ROOM
- 3 - DINING ROOM
- 4 - KITCHEN
- 5 - UTILITY
- 6 - BEDROOM - 1
- 7 - MASTER SUITE
- 8 - MASTER TOILET
- 9 - COMMON TOILET
- 10 - BALCONY

## TYPICAL FLOOR

TYPE	WING	FLAT NO.	B.U.A	SALEABLE AREA
2 BHK	A	4 & 5	997	1245
2 BHK	C	2 & 3	997	1245

- ENTRANCE FOYER - 1
- LIVING ROOM - 2
- DINING ROOM - 3
- KITCHEN - 4
- UTILITY - 5
- BEDROOM - 1 - 6
- BEDROOM - 2 - 7
- MASTER SUITE - 8
- MASTER TOILET - 9
- COMMON TOILET - 10
- BALCONY - 11

## TYPICAL FLOOR

TYPE	WING	FLAT NO.	B.U.A	SALEABLE AREA
2.5 BHK	A	3	1136	1420



# GLEN GATE

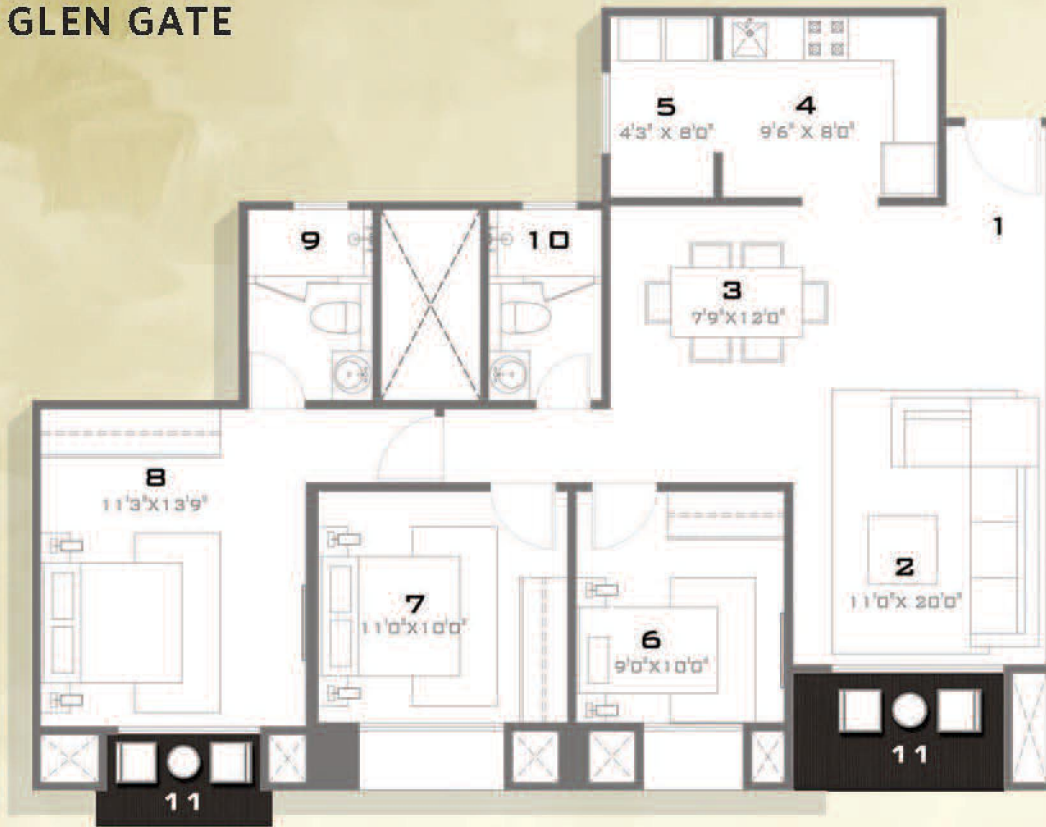

- 1 - ENTRANCE FOYER
- 2 - LIVING ROOM
- 3 - DINING ROOM
- 4 - KITCHEN
- 5 - UTILITY
- 6 - BEDROOM - 1
- 7 - BEDROOM - 2
- 8 - MASTER SUITE
- 9 - MASTER TOILET
- 10 - COMMON TOILET
- 11 - BALCONY

## TYPICAL FLOOR

TYPE	WING	FLAT NO.	B.U.A	SALEABLE AREA
2.5 BHK	C	4 & 5	1136	1420

- ENTRANCE FOYER - 1
- LIVING ROOM - 2
- DINING ROOM - 3
- KITCHEN - 4
- UTILITY - 5
- BEDROOM - 1 - 6
- BEDROOM - 2 - 7
- MASTER SUITE - 8
- MASTER TOILET - 9
- COMMON TOILET - 10
- BALCONY - 11

## TYPICAL FLOOR

TYPE	WING	FLAT NO.	B.U.A	SALEABLE AREA
2.5 BHK	C	1	1146	1430



# GLEN GATE



- 1 - ENTRANCE FOYER
- 2 - LIVING ROOM
- 3 - DINING ROOM
- 4 - KITCHEN
- 5 - UTILITY
- 6 - BEDROOM - 1
- 7 - BEDROOM - 2
- 8 - MASTER SUITE
- 9 - MASTER TOILET
- 10 - COMMON TOILET
- 11 - BALCONY

## TYPICAL FLOOR

TYPE	WING	FLAT NO.	B.U.A	SALEABLE AREA
2.5 BHK	A	6	1151	1440

- ENTRANCE FOYER - 1
- LIVING ROOM - 2
- DINING ROOM - 3
- KITCHEN - 4
- UTILITY - 5
- BEDROOM - 1 - 6
- BEDROOM - 2 - 7
- TOILET - 2 - 8
- MASTER SUITE - 9
- MASTER TOILET - 10
- COMMON TOILET - 11
- BALCONY - 12

## TYPICAL FLOOR

TYPE	WING	FLAT NO.	B.U.A	SALEABLE AREA
3 BHK	A	1	1447	1810



# GLEN GATE



- 1 - ENTRANCE FOYER
- 2 - LIVING ROOM
- 3 - DINING ROOM
- 4 - KITCHEN
- 5 - UTILITY
- 6 - BEDROOM - 1
- 7 - TOILET - 1
- 8 - BEDROOM - 2
- 9 - MASTER SUITE
- 10 - MASTER TOILET
- 11 - COMMON TOILET
- 12 - BALCONY

## TYPICAL FLOOR

TYPE	WING	FLAT NO.	B.U.A	SALEABLE AREA
3 BHK	B	2 & 3	1303	1630

- ENTRANCE FOYER - 1
- LIVING ROOM - 2
- DINING ROOM - 3
- KITCHEN - 4
- UTILITY - 5
- BEDROOM - 1 - 6
- TOILET - 1 - 7
- BEDROOM - 2 - 8
- MASTER SUITE - 9
- MASTER TOILET - 10
- COMMON TOILET - 11
- BALCONY - 12

## TYPICAL FLOOR

TYPE	WING	FLAT NO.	B.U.A	SALEABLE AREA
3 BHK	B	1 & 4	1330	1665



## GLEN GATE



- 1 - ENTRANCE FOYER
- 2 - LIVING ROOM
- 3 - DINING ROOM
- 4 - KITCHEN
- 5 - UTILITY
- 6 - BEDROOM - 1
- 7 - BEDROOM - 2
- 8 - TOILET - 2
- 9 - MASTER SUITE
- 10 - MASTER TOILET
- 11 - COMMON TOILET
- 12 - BALCONY

### TYPICAL FLOOR

TYPE	WING	FLAT NO.	B.U.A	SALEABLE AREA
3 BHK	C	6	1395	1740

- ENTRANCE FOYER - 1
- LIVING ROOM - 2
- DINING ROOM - 3
- KITCHEN - 4
- UTILITY - 5
- BEDROOM - 1 - 6
- BEDROOM - 2 - 7
- TOILET - 2 - 8
- MASTER SUITE - 9
- MASTER TOILET - 10
- COMMON TOILET - 11
- BALCONY - 12

### TYPICAL FLOOR

TYPE	WING	FLAT NO.	B.U.A	SALEABLE AREA
3 BHK	A	2	1408	1760





# HEBBAL

## GLEN GATE

KEY PLAN: TYPICAL FLOOR PLAN

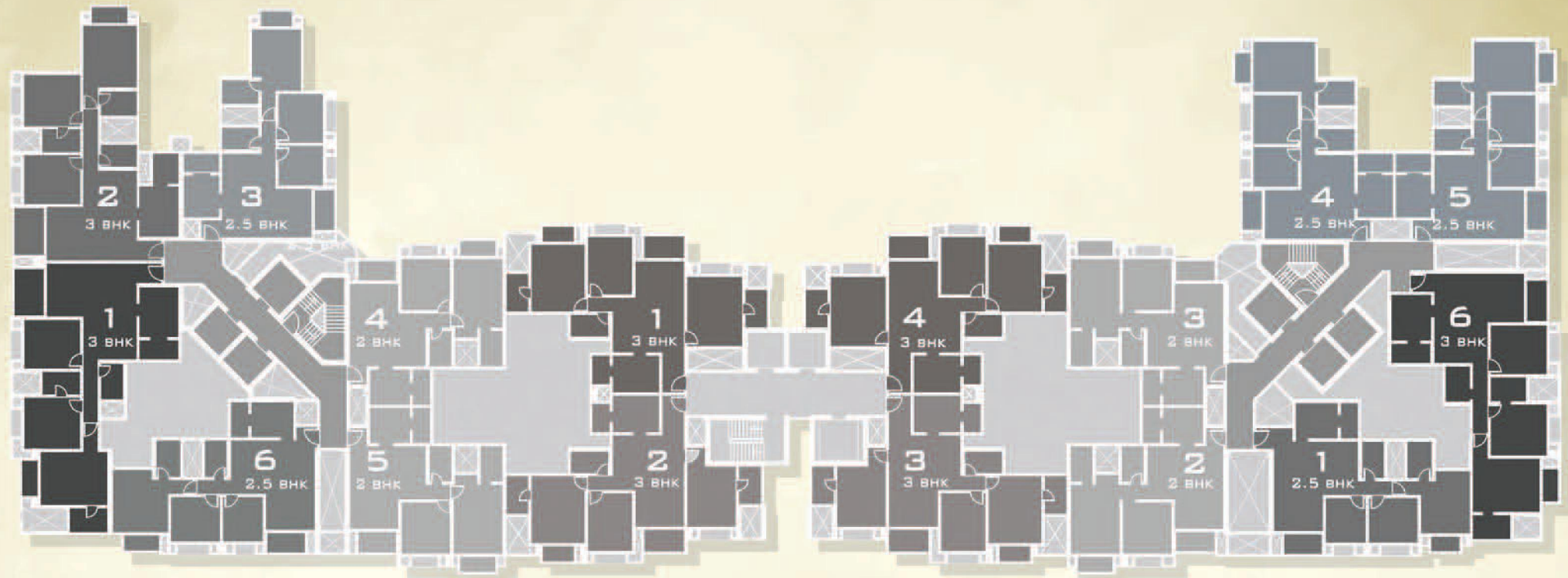
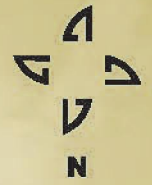

### WING - A

S + 18

#### WING - A

TYPE	FLAT NOS.	B. U. A.	SALEABLE AREA
3 BHK	1	1447	1810
3 BHK	2	1408	1760
2.5 BHK	3	1136	1420
2 BHK	4 & 5	997	1245
2.5 BHK	6	1151	1440

### WING - B

S + 18

#### WING - B

TYPE	FLAT NOS.	B. U. A.	SALEABLE AREA
3 BHK	1 & 4	1330	1665
3 BHK	2 & 3	1303	1630

### WING - C

S + 18

#### WING - C

TYPE	FLAT NOS.	B. U. A.	SALEABLE AREA
2.5 BHK	1	1146	1430
2 BHK	2 & 3	997	1245
2.5 BHK	4 & 5	1136	1420
3 BHK	6	1395	1740



HOUSE OF  
**HIRANANDANI**  
HEBBAL, BENGALURU

Kodigehalli Extension, Muncipal ward No. 15, Bytarayanapura city, Muncipal Council Bangalore North Taluka, Bangalore - 560092, Karnataka.

T: 1800 121 1234 E: [bangalore@houseofhiranandani.com](mailto:bangalore@houseofhiranandani.com); [info@houseofhiranandani.com](mailto:info@houseofhiranandani.com) W: [www.houseofhiranandani.com](http://www.houseofhiranandani.com)

The layout details, amenities and facilities mentioned/shown are subject to changes/relocation within the composite development/are subject to modification, amendment, changes and revocable, without any notice at the discretion of the Developer. Any location plans given are only indicative in nature and may not depict actual locations. Images used are for representative purpose only. \*Conditions apply.

The project is financed by ICICI Bank Ltd.

+918470930121 | [www.abcbuildcon.in](http://www.abcbuildcon.in)